

kindershapes | Owl

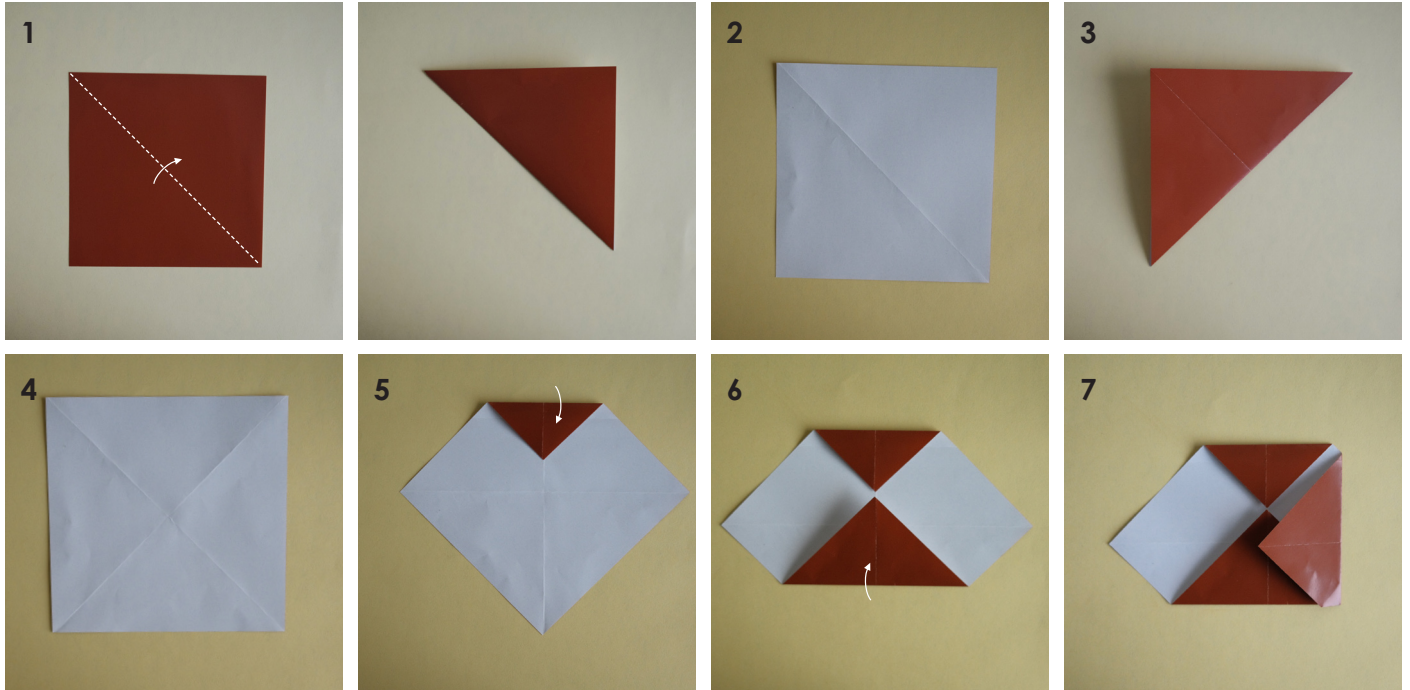

INSTRUCTIONS

1. Begin with a square Glossy Kinder Square, with the coloured side facing up. Fold in Half Diagonally. Fold the square diagonally in half to form a triangle.
2. Then unfold to create a crease in the center.
3. Create the Center Point. Fold the top corner down towards the center, and crease well. This fold will create the top point of the owl's face.
4. Unfold. Rotate 45 degrees.
5. Fold the top corner of the triangle down towards the center, creating a small triangular flap at the top.
6. Fold the lower corner of the triangle up towards the top corner of the folded triangle.
7. Fold the right side of the triangle towards the center, forming the right wing of the owl.
8. Fold the left side of the triangle towards the center, forming the left wing of the owl.
9. Draw eyes and feathers on the owl's face, adding details to bring the character to life.

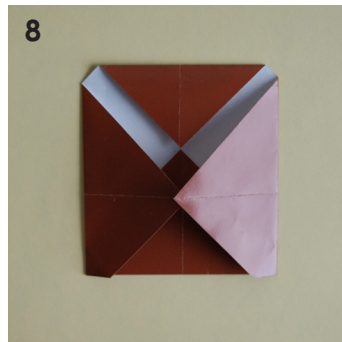

TOOLS

Black marker (for face)

PRODUCT:

- FI 27120 - Gloss Kinder Squares 127mm

CRAFT TEMPLATE:

Available at
www.austpaper.com.au/craft